

# SEVENTY 8

MOTOR YACHT





Détails options / Option list details

SEVENTY

8



LOA 23,80 m/ 78'1"  
LWL 23,05 m/ 75'8"  
BOA 11,00 m/ 36'1"  
Draft 1,27 m/ 4'2"  
Displacement 72 T/ xx Lbs  
Water 1500 Lt/ 396 Us gal  
Fuel 8500 Lt (2800 + 5700)/ 2 246 Us gal  
Optional engine JOHN DEERE N13-580 HP

| Catégorie de conception<br>Design Category   | A    | B    | C    | D    |
|--|------|------|------|------|
| MAX   | 14   | 18   | 24   | 40   |
| MAX (kg)  +  | 3830 | 3990 | 4170 | 5410 |

# SEVENTY8

MOTOR YACHT

**JOHN DEERE N13-580 HP**

**Engine Hours.**

**Port 2 561.**

**Stbd 2 546.**

**ONAN GENSET**

**Generator Hours**

**Port 4 374.**

**Stbd 4 516.**

**Generator service on 12 & 13 th September**





# AMENAGEMENT & FINITION

## Layout Version & finition

### Aft galley Version



# AMENAGEMENT & FINITION

## Layout Version & finition

- ❑ « PROPRIETAIRE » 3 Cabines - 3 Toilettes , Cuisine et équipage arrière
- « OWNER » 3 Cabins - 3 heads - Galley and crew aft



Option

# AMENAGEMENT & FINITION

## Layout Version & finition

- ❑ Porte de bordé ouvrante dans la cabine propriétaire (terrasse en teck protection, échelle de bain)  
Hydraulic opening hull door (balcony) in owner cabin (teak terrace and swim ladder)

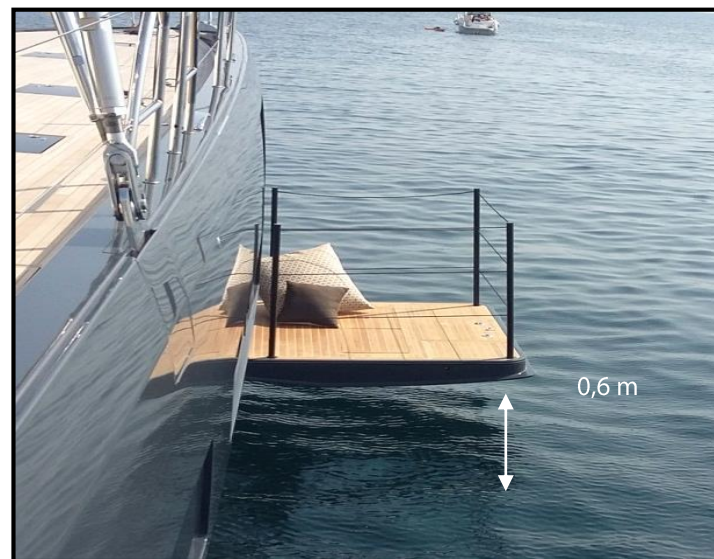
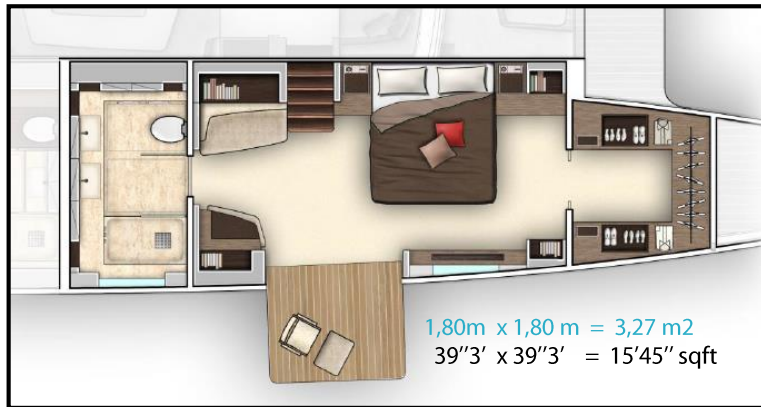



# AMENAGEMENT & FINITION

## Layout Version & finition

### CUISINE ARRIERE / AFT GALLEY

- ❑ Cabine équipage pointe avant Babord (1x lit, évier, douche toilette).  
Crew cabin in forward Portside bow compartment (1x bunk, sink shower, toilet)

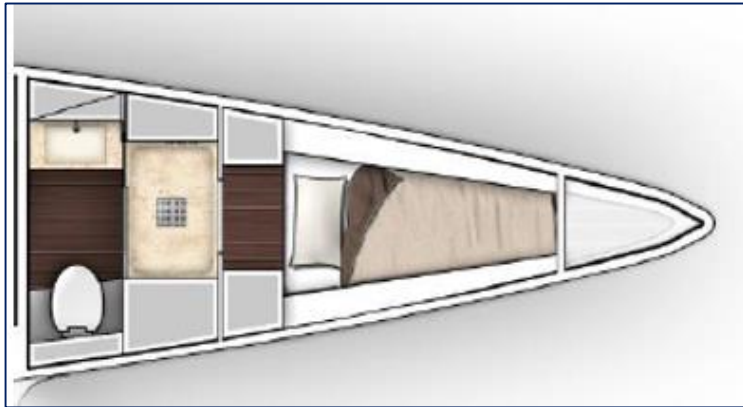

Fans are standard  
in forward crew cabin

- ❑ Couchage additionnel dans pointe avant Bâbord  
Additional bunk in forward portside bow  
compartment

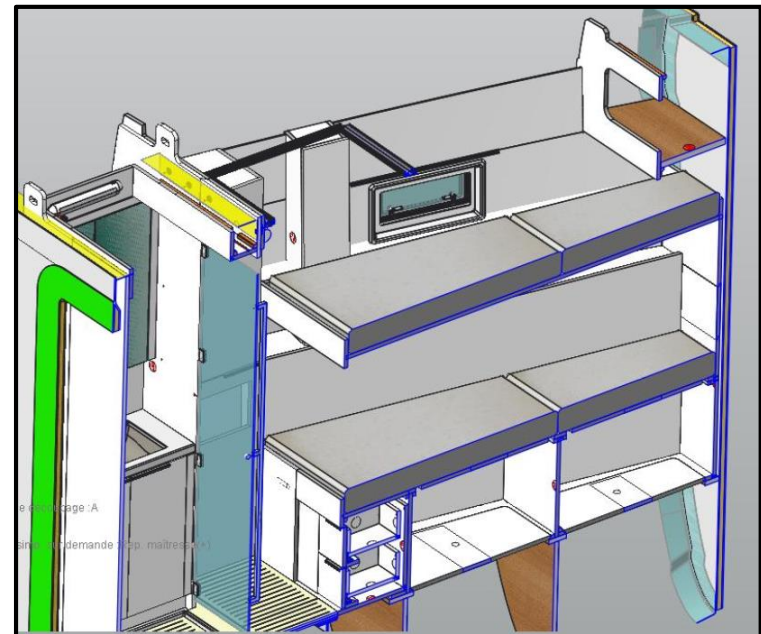

# AMENAGEMENT & FINITION

## Layout Version & finition

Toute version / All version layout

- ❑ Cabine équipage pointe avant Tribord (1x lit, évier, douche toilette).  
Crew cabin in forward starboard bow compartment (1x bunk, sink shower, toilet)

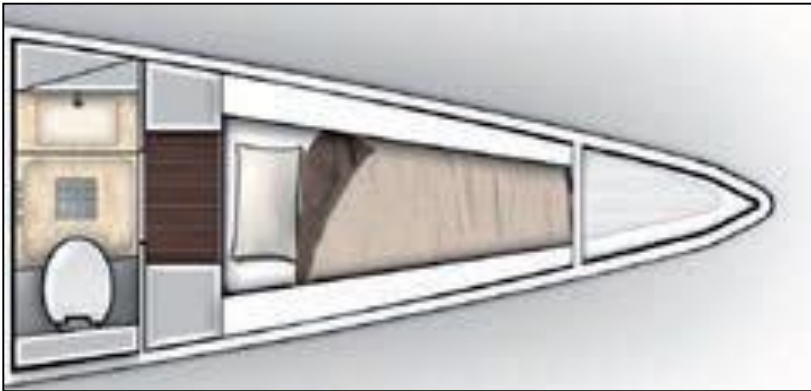

Fans are standard  
in forward crew cabin

- ❑ Couchage additionnel dans pointe avant Tribord  
Additional bunk in forward starboard bow  
compartment

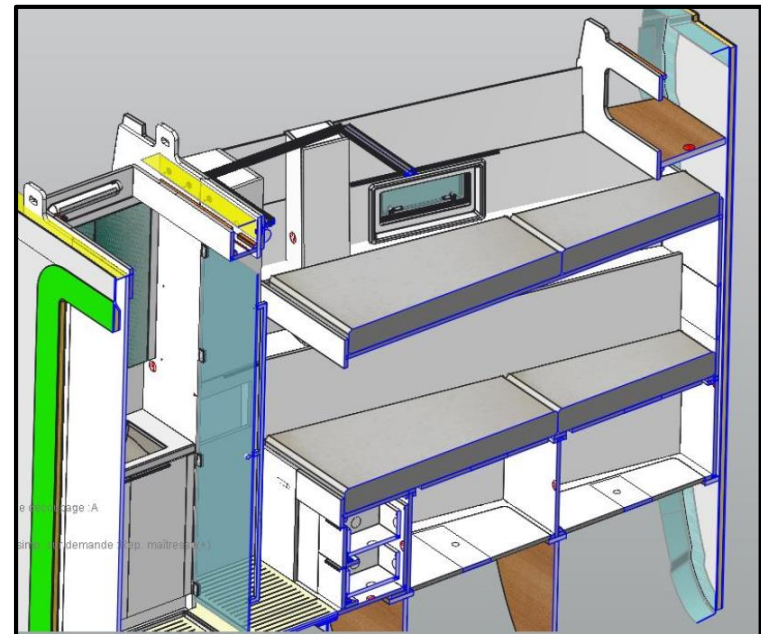



# AMENAGEMENT & FINITION

## Layout Version & finition

### Boiserie Standard / Standard Wood Finishing

#### ■ SALON & CABINS (grey oak UV varnish - Wengé floor - Corian)



#### ■ CREW QUARTER (finishing for all options)

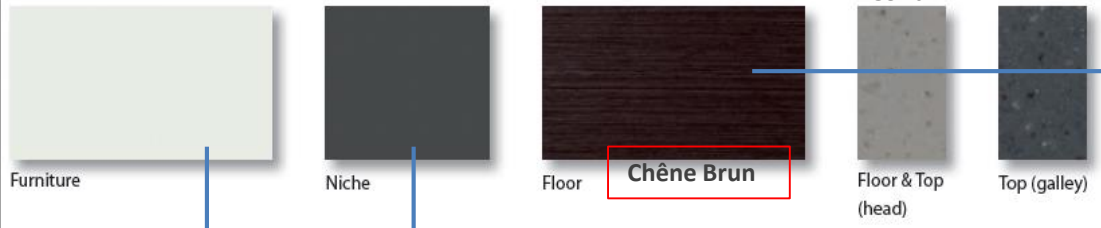

- ❑ **Chêne Gris Vernis UV**  
**Grey Oak UV varnish** :  
Alpi Chêne gris vernis UV, plancher  
Wengé, corian  
Light Oak UV varnish, Wengé floor,  
corian

Corian : 12 mm , 21,5 kg m<sup>2</sup>



Version cuisine avant : le Corian de salle de bain équipage identique à la cuisine.  
Forward galley version : Corian will be the same in galley and crew head

# AMENAGEMENT & FINITION

## Layout Version & finition

### Option Boiserie / Wood Finishing Option

- ❑ **Chêne Gris / Grey Oak brushed :**
  - ✓ Alpi Chêne gris brossé et vernis pores ouverts, plancher Wengé , Marbre
  - ✓ Grey Oak brushed & open grain varnish, Wengé floor, Marble



# SELLERIE Upholstery

## SELLERIE / UPHOLSTERY : AMBIANCE PURER

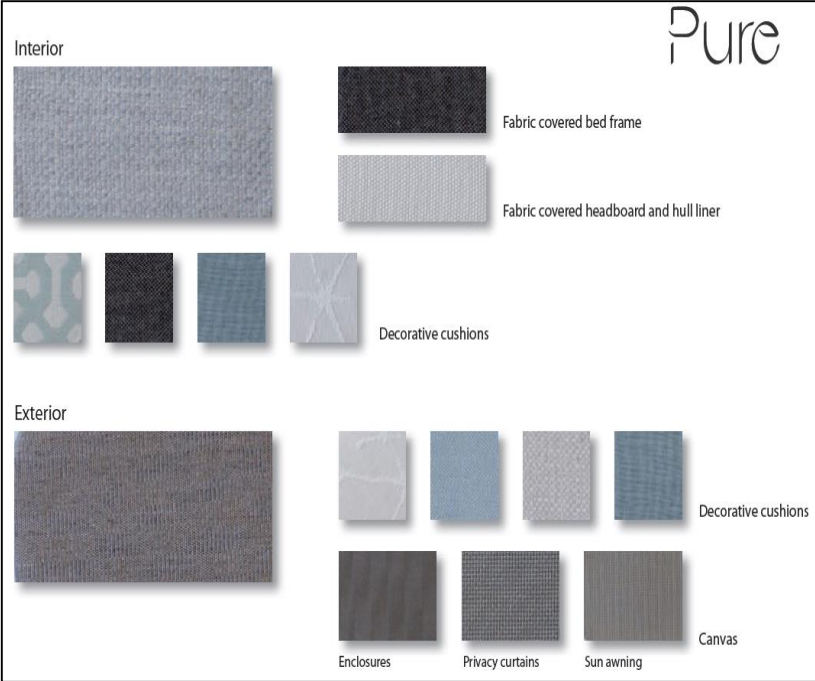



# MOQUETTES Carpet

## Tapis dans le salon / Carpets in the saloon (photos)

- ❑ Salon principal  
Main saloon



- ❑ Salon avant  
Forward saloon

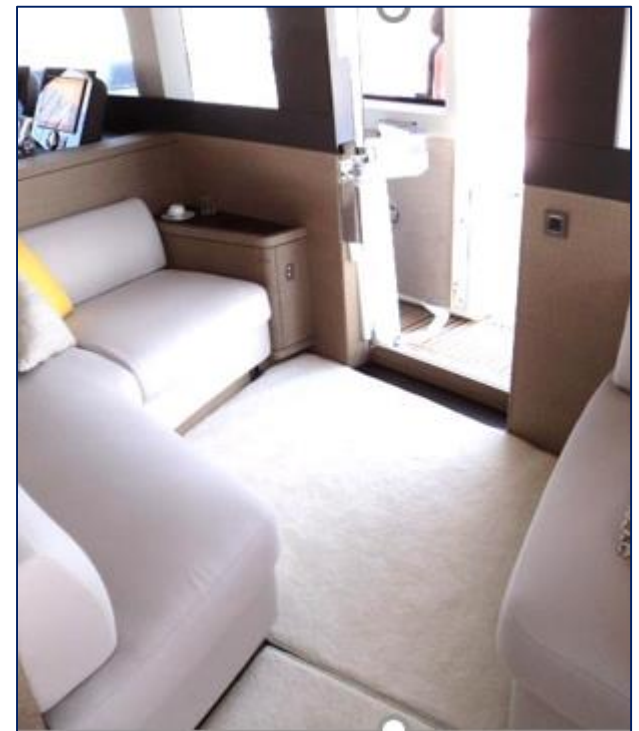

# SELLERIE Upholstery

## SELLERIE / UPHOLSTERY : AMBIANCE PURER

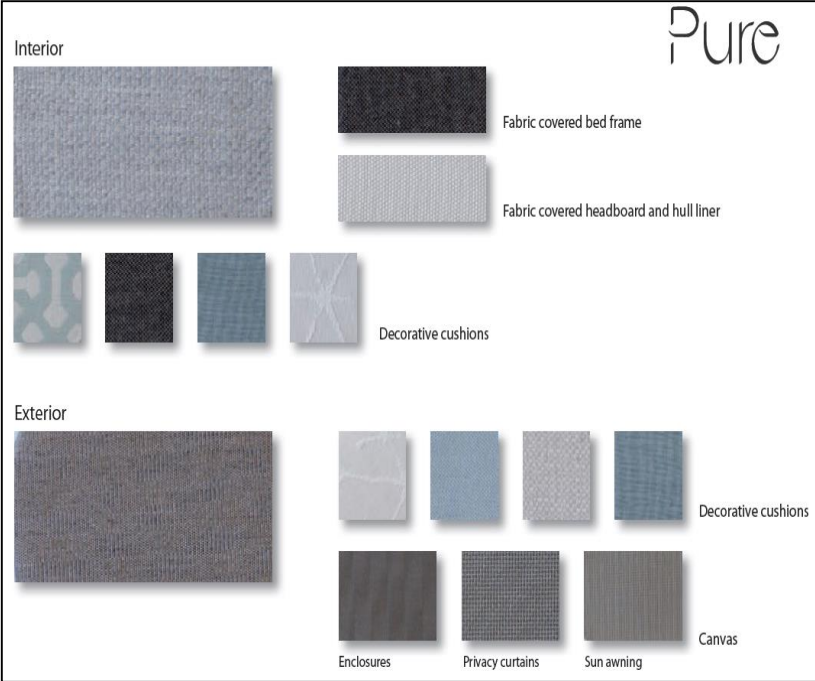

# MOQUETTES Carpet

- ❑ Tapis dans les cabines  
Carpet in all cabins





# EQUIPEMENT DE PONT

## Deck Equipment

*Pont en Teck standard, panneaux de pont flush / Teak deck in standard and Lewmar T60 flush hatches*



T60

# EQUIPEMENT DE PONT

## Deck Equipment

- ❑ Plateforme hydraulique avec télécommande (poids max : 850 kg, longueur disponible : 4,6m)  
Hydraulic aft platform with remote (max weight 850 kg; overall length 4,6 m)

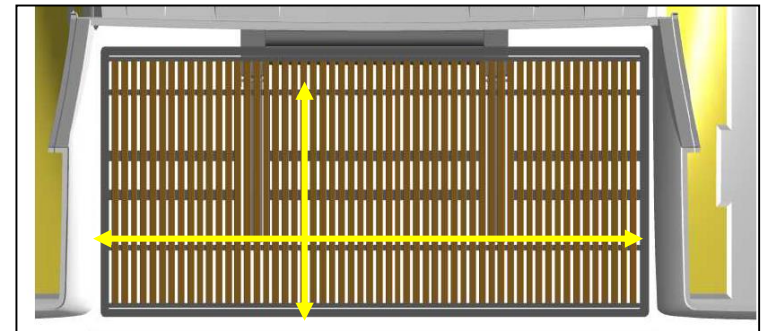

2,4m x 4,95m  
7,10 ft x 16,2 ft

# EQUIPEMENT DE PONT

## Deck Equipment

- ❑ Passerelle hydraulique rétractable dans la jupe bâbord (longueur extérieur coque : **xx mètres**)  
Retractable hydraulic gangway on portside transom (length over the hull **xx meters**)



*Panneau de contrôle dans le  
compartiment moteur +  
télécommande sans fil.*

*Panel control in engine room &  
wireless remote controle*





# EQUIPEMENT DE PONT

## Deck Equipment

- ❑ Plus value pour taquets rétractables (x8) et chaumards inox (x2)  
Extra for foldable cleats (x8) & fairleads (x2)



# EQUIPEMENT DE PONT

## Deck Equipment

- ❑ 2x Cabestans d'amarrage (2300 watt) à l'arrière avec capot de protection.
- 2x aft mooring cabstans (2300 watts) with protecting lid.



# EQUIPEMENT DE PONT

## Deck Equipment

- ❑ Echelle de coupée / Boarding ladder.

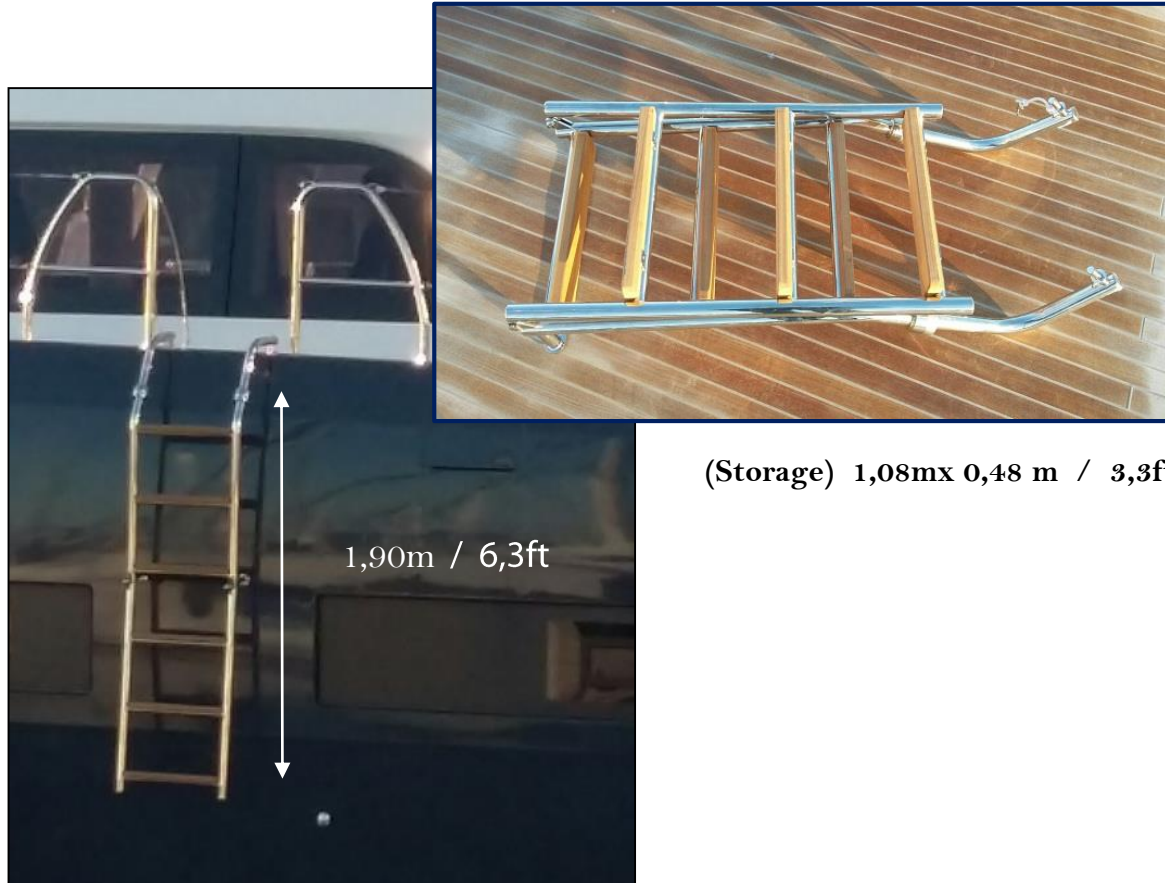



# EQUIPEMENT DE PONT

## Deck Equipment

- ❑ 2<sup>nd</sup> échelle de bain avec 2<sup>nd</sup> douchette de cockpit à bâbord  
2<sup>nd</sup> swim ladder with 2<sup>nd</sup> hot and cold water cockpit shower on portside



*Swim ladder and hot/cold water cockpit shower standard on Starboard  
Echelle de bain et douchette de cockpit standrd à tribord*

# EQUIPEMENT DE PONT

## Deck Equipment

- ❑ Colonne de douche (carbone et inox) amovible sur jupe arrière Tribord  
Starboard transom removable shower column (need pictures)



# EQUIPEMENT DE PONT

## Deck Equipment

- ❑ Kit de housses (barre à roue, poste de barre, table de cockpit, winchs, guindeau, assise)  
Kit of cover (steering wheels, nav stations, cockpit table, winches & windlass)



  
MARINE

Gris (silver) avec ambiance Nomad / Blanc avec ambiance Pure et Fusion. Silver with Nomad ambiance / White with Pure and Fusion Ambiance.

# EQUIPEMENT DE PONT

## Deck Equipment

- ❑ 2x spots LED dans la poutre arrière  
2x LED spot lights in aft beam)





# EQUIPEMENT DE PONT

## Deck Equipment

- ❑ 8x lumières sous marine bleues
- 8x Blue led underwater lights 24V



GEN4 séries 12



48 m

LG 77 picture

# EQUIPEMENT DE PONT

## Deck Equipment

- ❑ Coussins extérieur avec protections (cockpit avant+ pouf amovible, arrière et fly)  
Exteriors cushions with protection covers (aft & forward cockpit; GRP stool, flybridge)

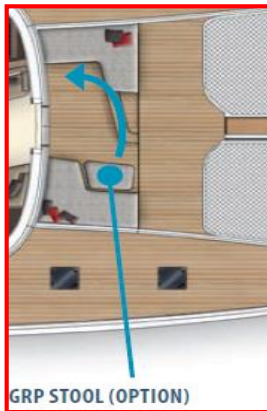

# EQUIPEMENT DE PONT

## Deck Equipment

- ❑ Toiles de fermeture de cockpit avec fenêtres et rideaux de courtoisies  
Cockpit enclosures with windows & courtesy curtains





# EQUIPEMENT DE PONT

## Deck Equipment

- ❑ Taud de soleil cockpit avant  
Forward cockpit sun awning with post



Couleur selon ambiance choisie / color from Ambiance selected



# EQUIPEMENT DE PONT

## Deck Equipment

Equipement de cockpit (bâbord)  
(Portside) Cockpit equipment

*Sink & Fridge 65 l Standard on starboard*



❑ ICE MAKER  
Vitrifrigo 220V 80 l

# EQUIPEMENT DE PONT

## Deck Equipment

Aménagement du Flybridge / Fly Bridge layout

### ❑ Loose Furniture



# EQUIPEMENT DE PONT

## Deck Equipment

- ❑ Flybridge composite bimini avec toit ouvrant, lumières pare brise et rideaux  
Flybridge composite bimini with electrical sliding top, lights, windshield and curtains

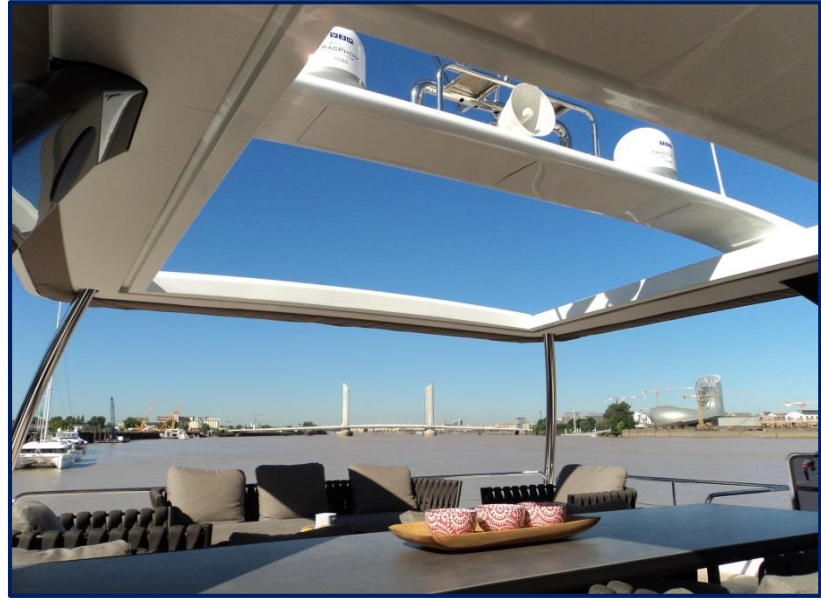



# EQUIPEMENT DE PONT

## Deck Equipment

- ❑ Toiles de tours de BIMINI avec vitrage (Leixan transparent)  
Flybridge enclosure for composite bimini (windows in clear Leixan)





# EQUIPEMENT DE PONT

## Deck Equipment

Equipement de Flybridge / Flybridge equipment

- ❑ Fond de Flybridge en teck  
Flybridge floor in teak



# EQUIPEMENT DE PONT Deck Equipment

Equipement de Flybridge / Flybridge equipment

*Evier & Frigo standard 65 l*  
*Sink & Standard fridge 65l*

❑ Grill Kenion Frontier  
Marine grade stainless steel 240 V  
1300 watt. (21"x12") (50x30cm)



❑ ICE MAKER  
Vitrifrigo 220V 80l



# EQUIPEMENT DE PONT

## Deck Equipment

- ❑ Hull Painted AURORA GOLD



# MOTEUR Engine

□ Moteur JOHN DEERE N13-580 Cv  
Cylindrée 13,6 l / additional alt : 24v 100 amp

Engine Hours.

Port : 2 561 h      Stbd : 2 546 h



|                            |  |                            |  |
|----------------------------|--|----------------------------|--|
| <b>Power at crankshaft</b> | 429 kW [583 hp]                              | <b>Engine base</b>         | John Deere   |
| <b>Displacement</b>        | 13.6 l [828 in³]                             | <b>Fuel system</b>         | Electronically controlled unit injectors                           |
| <b>Configuration</b>       | 6 cylinders in line<br>4 valves per cylinder | <b>Air intake</b>          | Turbocharged<br>Air-to-seawater aftercooler                        |
| <b>Operation type</b>      | 4 stroke Diesel                              | <b>Cooling</b>             | Closed cooling with heat exchanger                                 |
| <b>Bore &amp; Stroke</b>   | 132 x 165 mm [5.2 x 6.5 in]                  | <b>Mounting angle</b>      | 12° Front up<br>0° Front down                                      |
| <b>Compression ratio</b>   | 16.0:1                                       | <b>Alternator</b>          | 24 Volt<br>100 Amp   |
| <b>Rated speed</b>         | 2000 rpm                                     | <b>Rating</b>              | M3   |
| <b>Idle speed</b>          | 600 rpm                                      | <b>Emission compliance</b> | IMO Marpol Annex VI<br>NRMM (97/68/EC) Tier 3<br>EPA marine Tier 3 |
| <b>Peak torque</b>         | 2731 Nm                                      |                            |  |
| <b>Peak torque speed</b>   | 1500 rpm                                     |                            |  |
| <b>Dry weight</b>          | 1380 kg [3042 lb]                            |                            |  |



# MOTEUR Engine



## ❑ Moteur JOHN DEERE N13-580 Cv Cylindrée 13,6 l / alt : 24v 100 amp

John Deere N13-580 580cv  
2000 trs/mn

HELICES / propeller 5 pales 5 blades

CONDITIONS DES ESSAIS Vent / wind: NE 10nds  
Atmospheric conditions Mer / sea plate / flat

Reservoir fuel / Fuel tank capacity : 8 500 litres  
2 245 us gal  
Cruising speed 12 knots

POIDS DU BATEAU / weight = kg 71500 kg  
Bateau en essai chantier / Yard sea trial configuration

| Régime Moteur en Trs/mn<br>Engine rpm | Vitesse moyenne : nœuds<br>Average speed : knots |                                   | Conso moyenne / moteur (x1)<br>Fuel consumption / engine (x1) |            | Range mn |
|---------------------------------------|--|-----------------------------------|---|------------|----------|
|                                       |  | Charge moteur<br>Engine load<br>% | Conso moyenne / moteur (x1)<br>Fuel consumption / engine (x1) |            |          |
|                                       |  |                                   | L / H   | US Gal / H |          |
| mini 600                              | 6,2  | 22                                | 4,0   | 1,06       |          |
| 700                                   | 7,6  |                                   | 4,5   | 1,19       |          |
| 800                                   | 9,0  |                                   | 7,4   | 1,95       |          |
| 900                                   | 10,0   | 32                                | 10,0  | 2,64       | 3 600    |
| 1000                                  | 11,0   |                                   | 13,2  | 3,49       |          |
| 1100                                  | 11,6   |                                   | 17,4  | 4,60       |          |
| 1200                                  | 12,4   | 42                                | 24,5  | 6,47       | 1 858    |
| 1300                                  | 12,8   |                                   | 31,5  | 8,32       |          |
| 1400                                  | 13,2   |                                   | 40,0  | 10,57      |          |
| 1500                                  | 14,0   | 50                                | 50,0  | 13,21      |          |
| 1600                                  | 14,5   |                                   | 60  | 15,85      |          |
| 1700                                  | 16   |                                   | 70,5  | 18,62      |          |
| 1800                                  | 16,5   | 80                                | 83  | 21,93      |          |
| 1900                                  | 18,6   |                                   | 92  | 24,30      |          |
| 2030                                  | 20,8   | 100                               | 115   | 30,38      |          |

Informations non contractuelles.  
These informations are not contractual.

La vitesse moyenne est relevée au GPS / GPS speed  
La consommation en fuel est donnée en litre pour 1 moteur / Litre fuel consumption for one engine.

# MOTEUR Engine

- ❑ Supplément commande moteurs à la table à cartes + interface électronique  
Extra for electronic throttles at chart table with electronic interface



# MOTEUR Engine

- ❑ Double filtre gasoil avec alarme pour chaque moteur.  
Double diesel filters (RACOR) with alarm for each engine



# MOTEUR Engine

- ❑ Coupe orin sur ligne d'arbre  
Rope cutter on propeller shaft

Propeller shaft : diam 70 mm

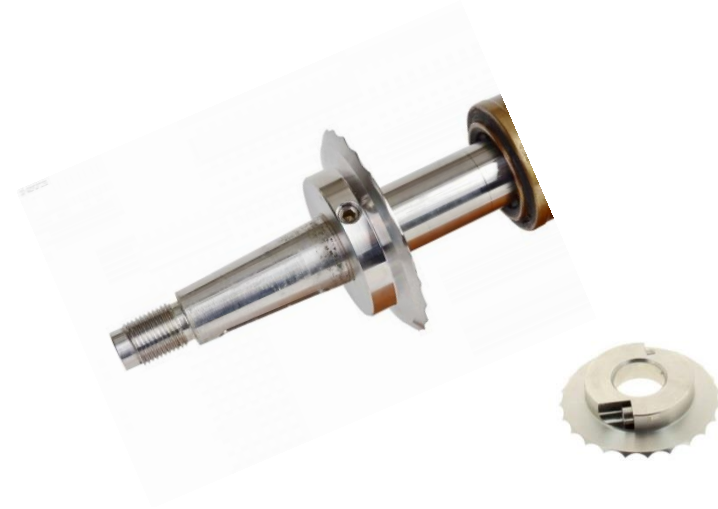

- ❑ Programme Hauturier/ OFF SHORE sailing  
Frein de ligne d'arbre et système de vidange électrique de l'huile moteur  
Shaft break and electrical engine oil drainer system





# MOTEUR & POSTE DE BARRE

## Engine & Helmstation

### ❑ Joystick de contrôle moteur (*John Deer Engine only*)

- ✓ Manual control of all propulsion elements with a joystick on each side
- ✓ Contrôle manuel des équipements de propulsion avec un joystick installé sur chaque bord

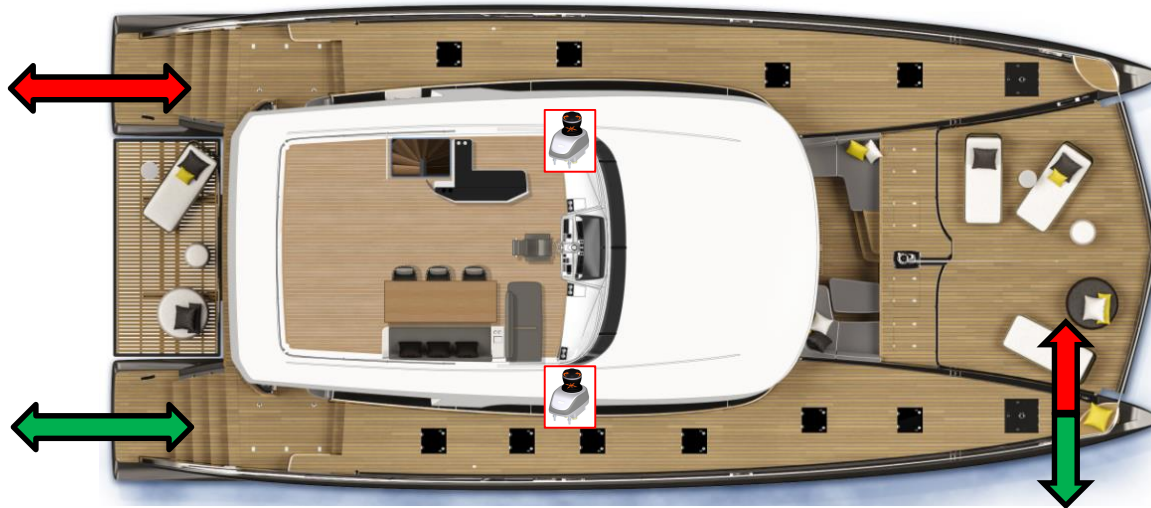

# MOTEUR & POSTE DE BARRE

## Engine & Helmstation

- ❑ Propulseur d'étrave électrique SIDE POWER à tribord  
Electrical bow thruster on starboard
- ✓ Parc batteries 48v /75Amp + chargeur dédié et panneau de contrôle  
✓ Battery bank 48v/75 amp + dedicated charger and control panel.



**SIDE POWER SP 285 (340 kgf / 48v)**  
Twin counter rotating  
Tunnel 300 mm

# ELECTRICAL CIRCUIT

## Electrical circuit

- ❑ Générateur supp. **ONAN 19 kva** 1500 trs/mn 220V/50Hz (modèle MDKBV) + pompe de transfert fuel  
Additional Genset **ONAN 19Kva** 1500trs/mn 220V / 50 Hz (Model MDKBV) and fuel transfert pump  
4 374 hours



- ❑ Générateur **ONAN 27Kva** 1500trs/mn (modèle MDKBU) + pompe de transfert fuel  
Genset **ONAN 27Kva** 1500trs/mn 220V / 50 Hz (model MGKBU) +fuel transfert pump  
4 516 hours



# ELECTRICAL CIRCUIT

## Electrical circuit

- ❑ Pack 2 x convertisseurs 24/220V 5000 VA / chacun  
Pack 2 x invertisers 24/220V 5000 VA / each  
(std = 1x 2kva or Option = 2x 5kva)
- ❑ Pack 2 x Chargeurs SKYLLA 220V 100 amp / chacun
- ❑ Pack 2 x Chargers SKYLLA 220V 100 amp / each  
(Std = 1 x100 amp. Option = 1x 100amp + 2x 100 amp = 300 amp total )

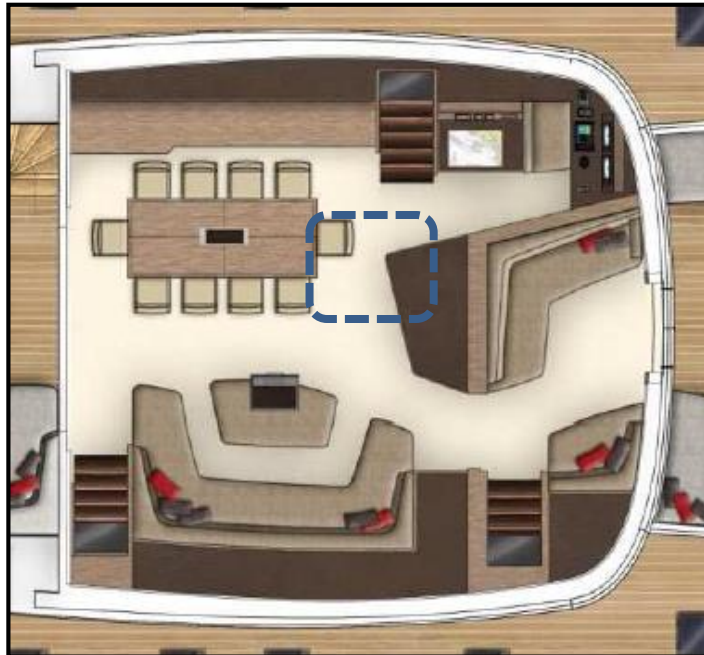

*Located under the saloon floor with battery bank*

# ELECTRICAL CIRCUIT

## Electrical circuit

- Yacht management monitoring système sur écrans B&G
- Yacht management monitoring system on B&G displays



### Fonctions disponible sur tous les écrans :

- AC/DC , Air conditionnée
- Feux de navigation et éclairage
- Niveau des batteries
- Niveaux des réservoirs de Fuel, eau douce, eaux grises et noires + centrale de traitement
- Dessalinisateurs
- Démarrage Générateur
- Message d'alerte,
- T°c salle des machines

### Functions displayed on all navigation screens

- AC/DC , Air conditioning
- Exterior & navigation lights
- Batteries level
- Fuel, Fresh water , grey & black tanks level and treatment system
- Watermakers
- Turn on / off Genset
- Warning pop up
- Engine room temperature

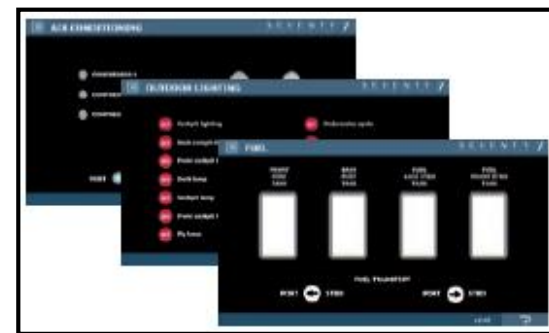

# CIRCUIT D' EAU

## Water circuit

- ❑ Dessalinisateur / Watermaker  
280 l/h SEA RECOVERY Aquamatic 220V



*Avec générateur 220V*  
*With 220v Genset*





# INSIDE LAYOUT

## Interior equipment

- ❑ Système de purification d'eau douce dans la cuisine avec robinet supp  
Freshwater purifier in the galley with additionnal faucet

Débit moyen Average return,: 3,8 l / min

Capacité totale Total capacity : 3'800 litres

Filtre Filter : 0.1 micron nominale (0,4 absolue)



**SEAGULL**  
West-Europe Inc.

# INSIDE LAYOUT

## Interior equipment

- ❑ Plus value porte de descente arrière bâbord électrique  
Port aft electrical companionway door



# INSIDE LAYOUT

Equipement electroménager cuisine arrière et avant  
Electrical appliance Aft & Forward galley version

## SALON / SALOON

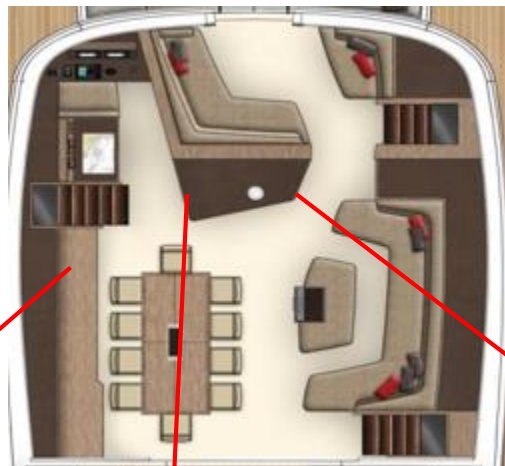

❑ Cave à vins / Win cellar  
16-20 bottles (220V)



❑ Frigo / Fridge  
130 liters (24V)



❑ Ice Maker  
Vitrifrigo (220V) 10kg/h



# INSIDE LAYOUT

## Interior equipment

### Electroménager zone équipage Cuisine arrière / Electrical appliance aft galley

- ❑ Lave & sèche linge 8kg / 5kg Miele  
Washer / Dryer MIELE
- ❑ Lave Linge Miele  
Washing machine 7kg Miele
- ❑ Sèche linge (7kg) Miele Dryer : Miele (7kg)
- ❑ Lave vaisselle 12 couverts Miele  
Dishwasher Miele 12 sets
- ❑ Congélateur sous plancher (92liters -20°C)  
Additional freezer under the floor
- ❑ Broyeur d'évier : Erator Evolution 200  
Sink crusher :
- ❑ (1) Micro Ondes +grill Miele: 6262 TC  
Micro waves + grill :
- ❑ (2) Machine à café intégrée Miele CVA6401  
Built-in coffe machine :



US fridge standard 220V : 396L (+) 124L (-)

# INSIDE LAYOUT

## Interior equipment

- ❑ Climatisation réversible 180 kbtu avec enrouleur électrique de prise de quai 100 Ah  
Reverse cycle chilled water air conditioning 180 kbtu with electrical reel for shorepower cord 100ah .



*Option Générateur ONAN 27 Kva obligatoire / Upgrade ONAN Genset 27kva needed*

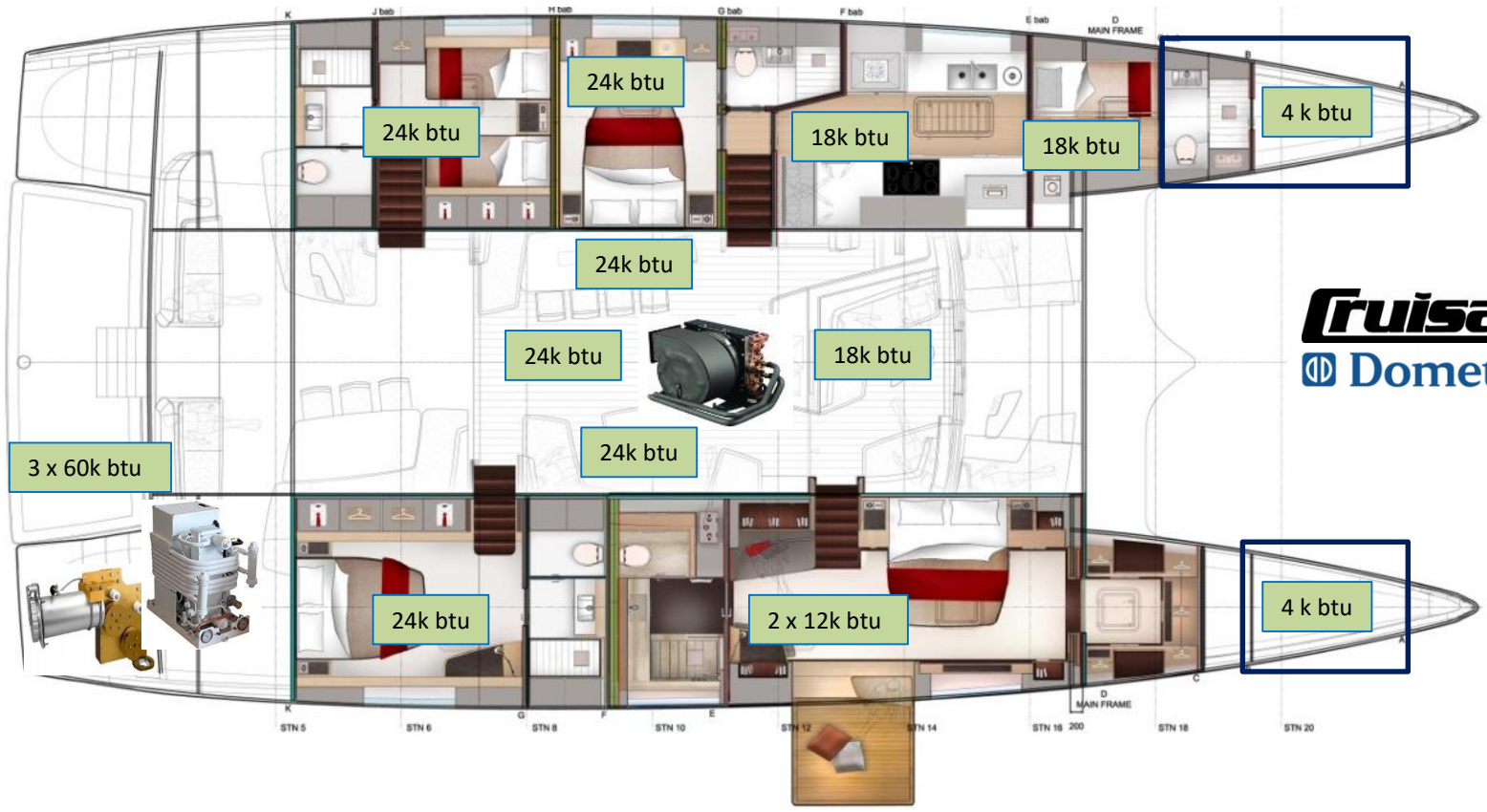

- ❑ Climatisation réversible dans la pointe avant bâbord et/ou Tribord (4Kbtu)  
Reverse chilled water air conditioning in port and / or starboard bow compartment

# Hi-Fi & Electronic

## PACK navigation SIMRAD

**NSS-16 touch screen**



**H5000 Triton Pilot Controller**

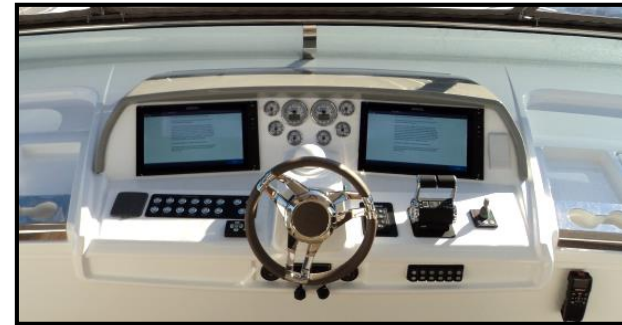

**Graphic Display H5000**

**CHART TABLE**

**MO-19 touch screen**



**Zeus<sup>2</sup> black box**



**H5000 Triton Pilot Controller**



**NAIS400 AIS Transponder**



**DT800 Depth/Temp Transducer**



**MHU 213 Wind Vane**



**SENSPD (Speed) H5000 Transducer**



**INTERNAL & EXTERNAL**

**Autopilot System**

RF25 Rudder Feedback



Precision-9 Drive LS 405T16 (from yard)



Pilot Computer H5000



**WIFI-1™ Wireless Module**

- Free "GoFree" application to view/control the MFD available from web



**Broadband Radar 4G**



**V90 VHF System and H50 Wireless Handset**



## Hi-Fi & Electronic

- ❑ Ecran Zeus B&G 12" dans la zone équipage  
B&G Zeus 12" Screen in crew area



Cuine arrière / aft Galley



# Hi-Fi & Electronic

## PACK navigation SIMRAD

Europ card



Rest of the world

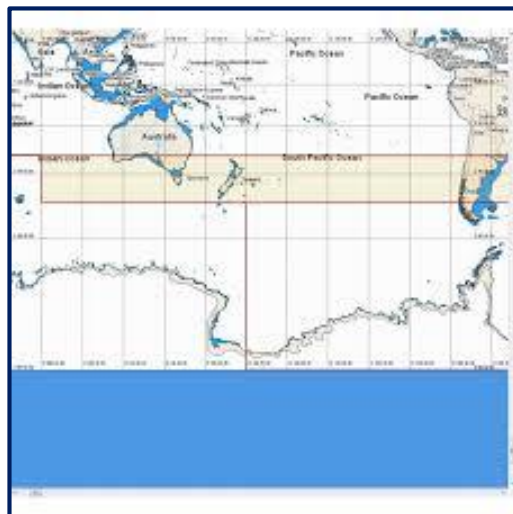

USA card



## Hi-Fi & Electronic

- ❑ Télécommande de pilote automatique / Auto pilote remote controle
  - ❑ Joystick à la table à cartes (pack B&G obligatoire) / Joystick at the chart table (pack B&G needed)
    - ❑ M-324XP Caméra de vision nocturne / Night vision camera
      - ❑ 2 caméras de sous le fly bridge / 2 cameras under flybridge

|   |  |  |  |
|---|--|--|--|
| <p><b>OPTIONAL<br/>REMOTE</b></p> <p>WR10 Wireless<br/>Autopilot Remote</p>  | <p><b>OPTIONAL<br/>CONTROL</b></p> <p>QS 80 Joystick</p>  | <p><b>OPTIONAL<br/>THERMAL CAMERA PACK*</b></p> <p>ZC2<br/>Remote</p>  <p>Thermal<br/>Camera<br/>(M324) S</p>  <p>RCA</p> <p>Video<br/>Splitter</p>  <p>RCA</p> | <p><b>OPTIONAL<br/>2 CAMERAS</b></p> <p>Navcams &amp;<br/>Video Splitter</p>  <p>navLam<br/>(rear)</p> <p>navLam<br/>(engine)</p> <p>RCA</p> |
|---|--|--|--|

# Hi-Fi & Electronic

- ❑ Sonde Forward scan  
Forward scan sounder

- ❑ Fish finder

**OPTIONAL**  
ZEUS MODULES

SonarHub™      ForwardScan®



The diagram shows two optional Zeus modules. On the left is the SonarHub, a black rectangular unit with three orange connectors on the front, connected to an Ethernet network. On the right is the ForwardScan, which includes a black transducer head and a silver mounting bracket, connected to a black cable with a square icon showing a sonar scan. The label 'FORWARDSCAN®' is positioned below the transducer.

Ethernet      FORWARDSCAN®

**OPTIONAL**  
ZEUS MODULES

SonarHub™ & Bronze HDI  
Transducer 50/200/455/800



The diagram shows another optional Zeus module setup. It features the SonarHub unit connected to an Ethernet network. Next to it is a square icon with a downward-pointing arrow and three curved lines, labeled 'DOWNSCAN IMAGING™'. Below the SonarHub is a circular Bronze HDI Transducer, also connected to the Ethernet network.

DOWNSCAN  
IMAGING™      Ethernet



# Hi-Fi & Electronic

## Salon / Saloon

- ❑ Hi-Fi sound system MEDIA CENTER Atoll dans le salon / in the saloon
  - ✓ HP et caisson de basse dans la salon 4+1 Loud speaker & subwoofer, 4+1 salon
  - ✓ 4 HP dans le cockpit arrière 4 aft cockpit,
  - ✓ 2 HP dans le cockpit avant 2 forward cockpit,
  - ✓ Ecran de TV 55' rétractable dans le plafond Foldable ceiling TV 55"
  - ✓ Réseau DLNA dans les cabine avec télécommande DLNA network for cabin, radio frequency remote + touch screen





## Hi-Fi & Electronic

### Cabines et cuisine arrière / Cabin and aft galley

- ❑ **Hifi sound system & TV 40'** sur ascenseur dans la cabine avant tribord et cabine propriétaire  
Hi-Fi sound system & TV 40' with lift in forward portside cabin & owner's cabin



- ❑ **Hifi sound system & TV 32** dans la cuisine  
Hi-Fi sound system & TV 32' in the galley



- ❑ **Hifi sound system seulement dans la cabine arrière tribord**  
Hi-Fi sound system only in aft starboard cabin

# Hi-Fi & Electronic

- ❑ Satellite communication system  
Mini Vsat V3ip : Voice and data



- ❑ Satellite TV SAILOR 900



- ❑ WIFI & 4G internet connexion
  - ✓ Make wifi on board with your 4G connexion
  - ✓ Marina / external wifi relay



**US & ROW**

- ❑ Antenne TV Omnimax dans le mât (TV , AM, FM)  
Omnimax mast antenna



## ACCESSOIRES / ACCESSORIES

❑ Tender WILLIAMS SPORT JET 460 Rotax 4-Tec 150 HP



|                 |  |
|-----------------|--|
| LOA :           | 4.60m/15ft 1in                                       |
| BEAM :          | 2.01m/6ft 7in  |
| DRY WEIGHT:     | 550kg/1212lb   |
| OVERALL HEIGHT: | 1.4m/4ft 7in, 1.10m/3ft 7in (with windscreen folded) |
| ENGINE :        | Rotax 4-TEC 150                                      |
| FUEL CAPACITY:  | 100 litres/26 US gal                                 |
| SEATING:        | 6 persons  |
| MAX SPEED:      | 77kph/48mph  |